

Wellis®

Klikk-klakk drain installation



Clear the basin outlet hole

Prevent water leakage caused by debris between the Klikk-klakk drain and the basin



Insert the Klikk-klakk drain

The gasket is placed down into the Klikk-klakk drain, inserted into the basin hole, and the gasket is tightly attached to the Klikk-klakk drain. (when pop-up have overflow hole, it should face to basin overflow hole)

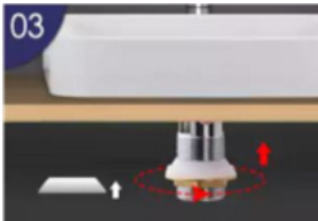

Screw nut

Put the gasket from the lower part, the small head is facing up, and tighten the nut to complete the installation of the Klikk-klakk drain.

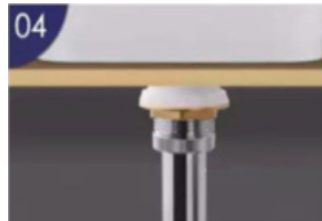

Tighten the drain body

Tighten the drain body, install the drain pipe, and you're done.

Wellis®

Klikk-klakk lefolyó beüzemelése

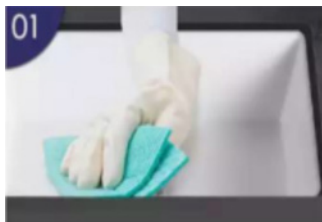

Tisztítsa meg a mosdó lefolyó nyílását

Előzze meg a vízvívárgást, amely a leeresztő és a mosdó közötti törmelék okozhat



Helyezze be a Klikk-klakk leeresztőt

A tömítéssel lefelé helyezze be a Klikk-klakk leeresztőt a mosdó lefolyó nyílásába, és a tömítést szorosan feküdjön fel a leeresztőre (ha a leeresztőn van túlfolyó nyílás, akkor annak a mosdó túlfolyó nyílása felé kell néznie).

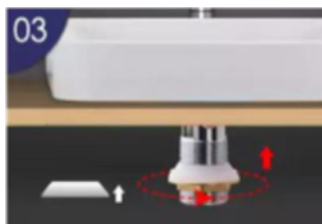

Alsó rögzítés

Helyezze fel a leeresztőre alsó tömítést és a rögzítő anyát a kisebbik felével felfelé (mint a képen), és húzza meg az anyát, hogy befejezze a Klikk-klakk leeresztőt telepítését.



Szerelje fel a vízvezetőt

Szerelje fel a leeresztőre a vízvezető elemet, szifont.

Wellis®

Punerea în funcțiune a ventilului click-clack

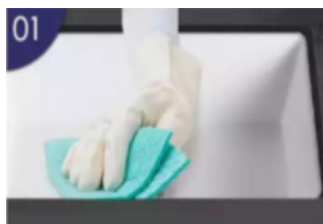

Curățați orificiul de scurgere a chiuvetei

Verificați dacă există scurgeri de apă cauzate de resturile dintre ventil și chiuvetă



Introduceți mecanismul de evacuare click-clack

Așezați mecanismul de evacuare click-clack cu garnitura în jos, astfel încât garnitura să fie lipită de evacuare (dacă orificiul de preaplin este după evacuare, aceasta trebuie orientată spre orificiul de preaplin).

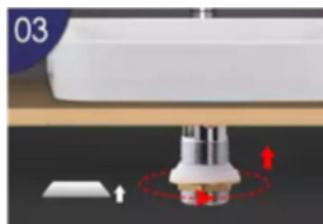

Montare inferioară

Așezați garnitura inferioară pe ventil și piulița de strângere cu partea mai mică în sus (conform schiței) și strângeți piulița pentru a finaliza montarea ventilului click-clack.



Montați elementul de evacuare a apei

Montați elementul de evacuare a apei, sifonul.